

# EcoLine W 100 E – W 400 E

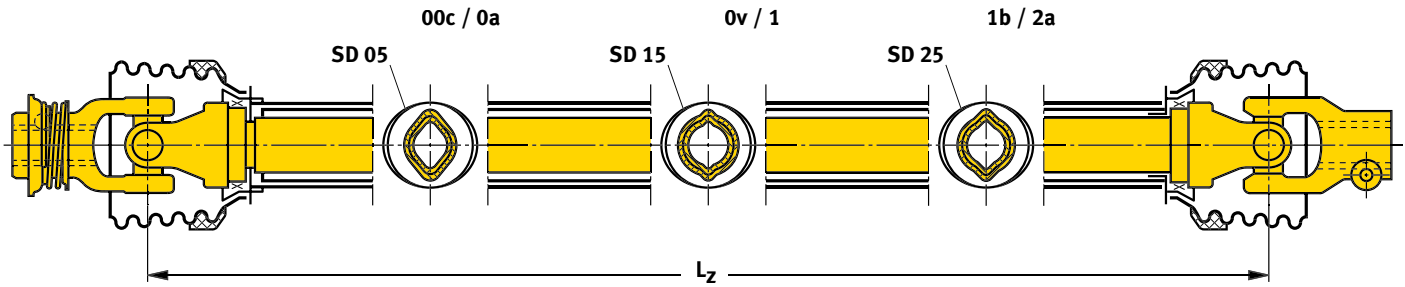

- ▶ Gelenkwellen-Baureihe **W 100 E – W 400 E**  
**Die wirtschaftliche Alternative**
- ▶ PTO drive shaft range **W 100 E – W 400 E**  
**The economic design alternative**
- ▶ Série de transmissions **W 100 E – W 400 E**  
**L'option économique**



|   |           |                                   |     |      |      |
|---|-----------|-----------------------------------|-----|------|------|
| Gelenkwellenlänge +/- 10mm (zusammengeschoben)<br>Shaft length +/- 10 mm (compressed)<br>Entr'axe de la transmission +/- 10mm (complètement comprimée)  | $L_Z$     | <b>Baugröße<br/>Size<br/>Type</b> | 560 | 710  | 1010 |
| Profilüberdeckung (zusammengeschoben)<br>Profile overlap (compressed)<br>Recouvrement des profils (transmission complètement comprimée)   | $PU_{LZ}$ | <b>W 100 E</b>                    | 435 | 585  | 885  |
|   |           | <b>W 200 E</b>                    | 425 | 565  | 865  |
|   |           | <b>W 300 E</b>                    | 405 | 545  | 845  |
|   |           | <b>W 400 E</b>                    | 395 | 535  | 835  |
| Max. Gelenkwellenlänge im Betrieb $L_B = L_Z + \frac{1}{2} PU_{LZ}$<br>Max. shaft length in operation $L_B = L_Z + \frac{1}{2} PU_{LZ}$<br>Longueur maxi au travail $L_B = L_Z + \frac{1}{2} PU_{LZ}$   | $L_B$     | <b>W 100 E</b>                    | 780 | 1005 | 1455 |
|   |           | <b>W 200 E</b>                    | 770 | 995  | 1445 |
|   |           | <b>W 300 E</b>                    | 760 | 985  | 1435 |
|   |           | <b>W 400 E</b>                    | 760 | 985  | 1435 |
| Min. Profilüberdeckung (im Betrieb)<br>Min. profile overlap (in operation)<br>Recouvrement mini des profils (au travail)  | $PU_{LB}$ | <b>W 100 E</b>                    | 215 | 290  | 440  |
|   |           | <b>W 200 E</b>                    | 215 | 280  | 430  |
|   |           | <b>W 300 E</b>                    | 205 | 270  | 420  |
|   |           | <b>W 400 E</b>                    | 195 | 260  | 410  |
| Max. Gelenkwellenlänge im Stillstand $L_T = L_Z + \frac{3}{4} PU_{LZ}$<br>Max. shaft length at standstill $L_T = L_Z + \frac{3}{4} PU_{LZ}$<br>Longueur maxi au repos $L_T = L_Z + \frac{3}{4} PU_{LZ}$ | $L_T$     | <b>W 100 E</b>                    | 885 | 1150 | 1675 |
|   |           | <b>W 200 E</b>                    | 880 | 1135 | 1660 |
|   |           | <b>W 300 E</b>                    | 860 | 1125 | 1650 |
|   |           | <b>W 400 E</b>                    | 855 | 1110 | 1635 |

**Leistungstabelle – Gelenk / Table of power ratings – Joint / Tableau des puissances – Joint**

|                | Grenzwerte<br>Limit values<br>Valeurs limites<br>Mp [Nm] (inlb) | Dynamische Kapazität / Dynamic capacity / Capacités dynamiques<br>P [kW] (PS/HP/ch) |                        |
|----------------|---|---|------------------------|
|                |   | 540 min <sup>-1</sup>   | 1000 min <sup>-1</sup> |
|                |   | <b>W 100 E</b>  | 1000 (8850)            |
| <b>W 200 E</b> | 1500 (13275)  | 20 (27)   | 31 (42)                |
| <b>W 300 E</b> | 2200 (19470)  | 28 (38)   | 44 (60)                |
| <b>W 400 E</b> | 3400 (30090)  | 39 (53)   | 61 (83)                |

**Leistungstabelle – Schiebepprofile / Table of power ratings – Telescopic sections / Tableau des puissances – Profils coulissantst**

| Rohrprofile<br>Profile Tubes<br>Tubes profilés | Mp   | Schiebekraft – Drehmoment / Thrust force – Torque / Effort au coulissement – Couple<br>[Nm] |
|--|------|---|
|  | [Nm] | Profile gefettet / Lubricated shaft sections / Profils graissés                             |
| <b>00c / 0a</b>                                | 600  | 13  |
| <b>0v / 1</b>                                  | 1400 | 11  |
| <b>1b / 2a</b>                                 | 2100 | 9   |

Mp = gibt die Grenze der statischen Belastbarkeit an.

Mp = specifies the static load limit.

Mp = donne la limite statique de charge.

**Bestelltext / Ordering details / Texte de commande**

|  |                  |                             |  |   |  |                          |                                 |
|--|------------------|-----------------------------|--|---|--|--------------------------|---------------------------------|
| Drehzahl<br>Speed .....[min <sup>-1</sup> ]<br>Régime<br>de rotation | Baugröße<br>Size | Gelenkwellenschutz<br>Guard | Länge $L_Z$<br>Mitte-Mitte<br>Gelenk [mm]<br>Joint c/c<br>length<br>$L_Z$ [mm] | Überlast- oder<br>Freilaufkupplung<br>Overload or over-<br>running clutch | Drehmoment Über-<br>lastkupplung [Nm]<br>Overload clutch<br>setting [Nm] | Anschlüsse<br>End yokes  | Profilpaarung<br>Profile mating |
| Drehrichtung<br>Direction<br>of rotation<br>Sens de<br>rotation      | Type             | Protecteur                  | Longueur $L_Z$<br>entr'axe des<br>croisillons [mm]                             | Limiteur de couple<br>ou roue libre                                       | Tarage du<br>limiteur [Nm]   | Mâchoires<br>d'extrémité | Profils int./ext.               |
|  |                  |                             |  |   |  | /                        |                                 |

Gelenkwelle  
PTO drive shaft  
Transmission

# W 100 E

(austauschbar mit W 2100)  
(interchangeable with W 2100)  
(interchangeable avec W 2100)



## Identifizierung – Maßtabelle / Identification – Table of dimensions / Identification – Tableau des cotes

| Baugröße<br>Size<br>Dimension | Gelenkkreuz<br>Cross joint<br>Bloc croisillon | Gabel<br>Yoke<br>Mâchoire | Profilpaarungen<br>Profile matings<br>Profils int./ext. | Schutzrohre<br>Guard tubes<br>Tubes protecteurs | SC/SD |
|-------------------------------|---|---------------------------|---|---|-------|
| <b>W 100 E</b>                |   |                           |   |   |       |

Schutztrichter  
Guard cones  
Cônes protecteurs

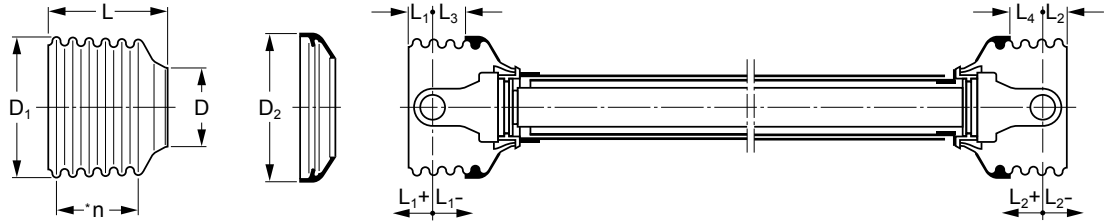

### SD 05/ SC 05

| D  | D <sub>1</sub> | D <sub>2</sub> | L  | L <sub>1</sub> | L <sub>2</sub> | L <sub>3</sub> | L <sub>4</sub> | *n       | Schutztrichter<br>Guard cones<br>Cônes protecteurs |                                      | Stützring<br>Reinforcing collar<br>Bague de renfort |                                      |
|----|----------------|----------------|----|----------------|----------------|----------------|----------------|----------|--|--------------------------------------|---|--------------------------------------|
|    |                |                |    |                |                |                |                |          | Zeichn.-Nr.<br>Drawing No.<br>Réf. du plan         | Bestell-Nr.<br>Part No.<br>Référence | Zeichn.-Nr.<br>Drawing No.<br>Réf. du plan          | Bestell-Nr.<br>Part No.<br>Référence |
| 62 | 132            | 127            | 90 | 24             | 24             | 27             | 27             | 5        | 85.05.05   | 365258                               | 83.10.03  | 365884                               |
|    | 163            |                | 97 | 97             | 10             |                |                | 85.05.10 | 365263   |                                      |   |                                      |
|    |                | 132            |    |                |                |                |                |          |  |                                      |   |                                      |

\*n = Rippenzahl (Andere Ausführungen auf Anfrage)

\*n = No. of ribs (Other versions on request)

\*n = Nombre d'ondes (Autres versions sur demande)

## Gelenkwellenanschlüsse – Gelenkkreuz / Drive shaft yokes – Cross joint / Accouplements correspondants – Bloc croisillon

| D  | D <sub>1</sub> | D <sub>2</sub> | L  | L <sub>1</sub> | L <sub>2</sub> | L <sub>3</sub> | N                | N <sub>1</sub> | G   | Zeichn.-Nr.<br>Drawing No.<br>Réf. du plan | Bestell-Nr.<br>Part No.<br>Référence |  | AZG  |
|--|----------------|----------------|----|----------------|----------------|----------------|------------------|----------------|-----|--|--------------------------------------|--|------|
| 1 3/8" (6)   | 84             |                | 96 | 56             | 20             |                |                  |                |     | 10.83.40                                   | 134744                               |  |      |
| 1 3/8" (21)  | 84             |                | 96 | 56             | 20             |                |                  |                |     | 10.83.41                                   | 134745                               |  |      |
| 8 x 32 x 38 (8)                                    | 84             |                | 96 | 56             | 20             |                |                  |                |     | 10.83.42                                   | 147613                               |  |      |
| 1 3/8" (6)   | 48             | 13             | 89 | 51             | 14             | 21,5           |                  |                |     | 10.10.00                                   | 040154                               |  | AG   |
| 1 3/8" (21)  | 48             | 13             | 89 | 51             | 14             | 21,5           |                  |                |     | 10.50.00                                   | 040460                               |  |      |
| 8 x 32 x 38 (8)                                    | 48             | 13             | 89 | 51             | 14             | 23,2           |                  |                |     | 10.34.110                                  | 083069                               |  |      |
| 1 3/8" (6)   | 48             | M12            | 89 | 51             | 14             | 21,5           |                  |                |     | 10.10.06                                   | 040162                               |  | AGKF |
| 30 H8  | 48             | M12            | 89 | 51             | 14             | 19             | 8 <sup>159</sup> | 33,3           |     | 10.10.162                                  | 356305                               |  |      |
|  |                |                |    |                |                |                |                  |                |     |  |                                      |  |      |
| 25 H8  | 45             | 10 H12         | 78 | 40             | 15             |                |                  |                |     | 10.22.133                                  | 040276                               |  | NG   |
| 30 H8  | 45             | 10 H12         | 78 | 40             | 15             |                |                  |                |     | 10.22.108                                  | 040251                               |  |      |
| 25 H8  | 45             |                | 78 | 40             | 20             |                | 8 <sup>159</sup> | 28,3           | M10 | 10.22.31                                   | 040217                               |  |      |
| 1 3/8" (6)   | 45             | 8 H12          | 78 | 40             | 15             |                |                  |                |     | 10.22.199                                  | 043317                               |  |      |
| 00c  |                | 8 H12          | 66 | 28             | 18             |                |                  |                |     | 10.48.00                                   | 040444                               |  | RG   |
| 0a   |                | 8 H12          | 66 | 28             | 18             |                |                  |                |     | 10.49.00                                   | 040456                               |  |      |
| <b>Gelenkkreuz / Cross joint / Bloc croisillon</b> |                |                |    |                |                |                |                  |                |     | 10.01.00                                   | 040116                               |  |      |

### Identifizierung – Maßtabelle / Identification – Table of dimensions / Identification – Tableau des cotes

| Baugröße<br>Size<br>Dimension | Gelenkkreuz<br>Cross joint<br>Bloc croisillon | Gabel<br>Yoke<br>Mâchoire | Profilpaarungen<br>Profile matings<br>Profils int./ext. | Schutzrohre<br>Guard tubes<br>Tubes protecteurs | SC/SD     |
|-------------------------------|---|---------------------------|---|---|-----------|
| <b>W 200 E</b>                |   |                           | <br><b>0v</b> <b>1</b>                                  |   | <b>15</b> |

### Schutztrichter Guard cones Cônes protecteurs

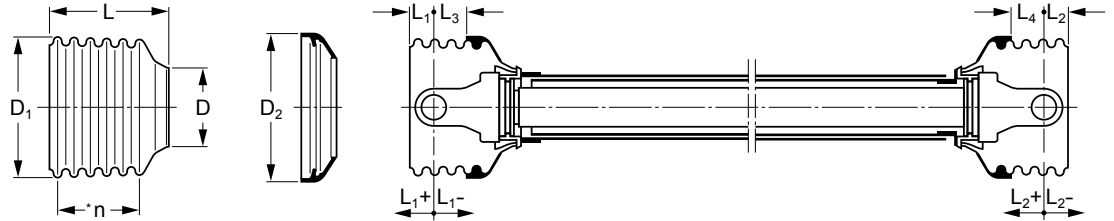

### SD 15/ SC 15

| D  | D <sub>1</sub> | D <sub>2</sub> | L   | L <sub>1</sub> | L <sub>2</sub> | L <sub>3</sub> | L <sub>4</sub> | *n | Schutztrichter<br>Guard cones<br>Cônes protecteurs |                                      | Stützring<br>Reinforcing collar<br>Bague de renfort |                                      |
|----|----------------|----------------|-----|----------------|----------------|----------------|----------------|----|--|--------------------------------------|---|--------------------------------------|
|    |                |                |     |                |                |                |                |    | Zeichn.-Nr.<br>Drawing No.<br>Réf. du plan         | Bestell-Nr.<br>Part No.<br>Référence | Zeichn.-Nr.<br>Drawing No.<br>Réf. du plan          | Bestell-Nr.<br>Part No.<br>Référence |
| 74 | 154            | 165            | 97  | 23             | 23             | 15             | 15             | 4  | 85.15.04   | 365344                               | 82.85.00  | 359471                               |
|    | 156            |                | 203 | 129            | 129            |                |                | 10 | 85.15.10   | 365350                               |   |                                      |

\*n = Rippenzahl (Andere Ausführungen auf Anfrage)

\*n = No. of ribs (Other versions on request)

\*n = Nombre d'ondes (Autres versions sur demande)

### Gelenkwellenanschlüsse – Gelenkkreuz / Drive shaft yokes – Cross joint / Accouplements correspondants – Bloc croisillon

| D   | D <sub>1</sub> | D <sub>2</sub> | L  | L <sub>1</sub> | L <sub>2</sub> | L <sub>3</sub> | N     | N <sub>1</sub> | G   | Zeichn.-Nr.<br>Drawing No.<br>Réf. du plan | Bestell-Nr.<br>Part No.<br>Référence |  | AZG  |
|---|----------------|----------------|----|----------------|----------------|----------------|-------|----------------|-----|--|--------------------------------------|--|------|
| 1 3/8" (6)                                  | 84             |                | 98 | 58             | 20             |                |       |                |     | 20.83.40                                   | 134746                               |  | AZG  |
| 1 3/8" (21)                                 | 84             |                | 98 | 58             | 20             |                |       |                |     | 20.83.41                                   | 134747                               |  |      |
| 8 x 32 x 38 (8)                             | 84             |                | 98 | 58             | 20             |                |       |                |     | 20.83.42                                   | 147614                               |  |      |
| 1 3/8" (6)                                  | 48             | 13             | 98 | 58             | 20             | 21,5           |       |                |     | 20.10.00                                   | 041049                               |  | AG   |
| 1 3/8" (21)                                 | 48             | 13             | 98 | 58             | 20             | 21,5           |       |                |     | 20.18.00                                   | 041130                               |  |      |
| 8 x 32 x 38 (8)                             | 48             | 13             | 98 | 58             | 20             | 23,2           |       |                |     | 20.11.128                                  | 366411                               |  |      |
| 1 3/8" (6)                                  | 48             | M12            | 98 | 58             | 20             | 21,5           |       |                |     | 20.10.02                                   | 041051                               |  | AGKF |
| 1 3/8" (21)                                 | 48             | M12            | 98 | 58             | 20             | 21,5           |       |                |     | 20.10.119                                  | 329012                               |  |      |
| 25 H8                                       | 48             | M12            | 98 | 58             | 20             | 16,5           | 8 JS9 | 28,3           |     | 20.19.121                                  | 087849                               |  |      |
| 30 H8                                       | 48             | M12            | 98 | 58             | 20             | 19             | 8 JS9 | 33,3           |     | 20.10.04                                   | 041055                               |  |      |
| 25 H8                                       | 46             | 8 H12          | 80 | 40             | 15             |                |       |                |     | 20.15.11                                   | 041082                               |  | NG   |
| 30 H8                                       | 46             | 10 H12         | 80 | 40             | 15             |                |       |                |     | 20.30.03                                   | 041154                               |  |      |
| 1 3/8" (6)                                  | 46             | 8 H12          | 80 | 40             | 15             |                |       |                |     | 20.38.101                                  | 041299                               |  |      |
| 25 H8                                       | 46             |                | 80 | 40             | 20             |                | 8 JS9 | 28,3           | M10 | 20.15.17                                   | 041088                               |  |      |
| 30 H8                                       | 46             |                | 80 | 40             | 20             |                | 8 JS9 | 33,3           | M10 | 20.30.05                                   | 041156                               |  |      |
| 0v  |                | 10 H12         | 75 | 35             | 22             |                |       |                |     | 20.11.00                                   | 041065                               |  | RG   |
| 1   |                | 10 H12         | 75 | 35             | 22             |                |       |                |     | 20.12.00                                   | 041068                               |  |      |
| Gelenkkreuz / Cross joint / Bloc croisillon |                |                |    |                |                |                |       |                |     | 20.00.00                                   | 044439                               |  |      |

**Identifizierung – Maßtabelle / Identification – Table of dimensions / Identification – Tableau des cotes**

| Baugröße<br>Size<br>Dimension | Gelenkkreuz<br>Cross joint<br>Bloc croisillon | Gabel<br>Yoke<br>Mâchoire | Profilpaarungen<br>Profile matings<br>Profils int./ext. | Schutzrohre<br>Guard tubes<br>Tubes protecteurs | SC/SD                              |
|-------------------------------|---|---------------------------|---|---|------------------------------------|
| <b>W 300 E</b>                |   |                           |   |   | <b>0v</b><br><b>1</b><br><b>15</b> |

**Schutztrichter  
Guard cones  
Cônes protecteurs**

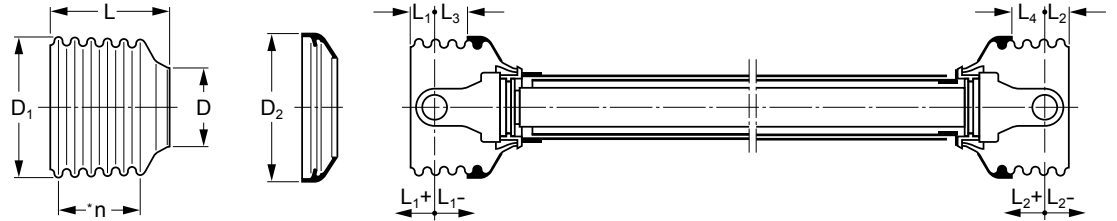

**SD 15/ SC 15**

|    |                |                |     |                |                |                |                |    | Schutztrichter<br>Guard cones<br>Cônes protecteurs |                                      | Stützring<br>Reinforcing collar<br>Bague de renfort |                                      |
|----|----------------|----------------|-----|----------------|----------------|----------------|----------------|----|--|--------------------------------------|---|--------------------------------------|
| D  | D <sub>1</sub> | D <sub>2</sub> | L   | L <sub>1</sub> | L <sub>2</sub> | L <sub>3</sub> | L <sub>4</sub> | *n | Zeichn.-Nr.<br>Drawing No.<br>Réf. du plan         | Bestell-Nr.<br>Part No.<br>Référence | Zeichn.-Nr.<br>Drawing No.<br>Réf. du plan          | Bestell-Nr.<br>Part No.<br>Référence |
| 74 | 156            | 165            | 114 | 30             | 30             | 25             | 25             | 5  | 85.15.05   | 365345                               | 82.85.00  | 359471                               |
|    | 156            |                | 203 | 119            | 119            |                |                | 10 | 85.15.10   | 365350                               |   |                                      |

\*n = Rippenzahl (Andere Ausführungen auf Anfrage)

\*n = No. of ribs (Other versions on request)

\*n = Nombre d'ondes (Autres versions sur demande)

**Gelenkwellenanschlüsse – Gelenkkreuz / Drive shaft yokes – Cross joint / Accouplements correspondants – Bloc croisillon**

| D  | D <sub>1</sub> | D <sub>2</sub> | L   | L <sub>1</sub> | L <sub>2</sub> | L <sub>3</sub> | N      | N <sub>1</sub> | G   | Zeichn.-Nr.<br>Drawing No.<br>Réf. du plan | Bestell-Nr.<br>Part No.<br>Référence | <b>AZG</b> |
|--|----------------|----------------|-----|----------------|----------------|----------------|--------|----------------|-----|--|--------------------------------------|------------|
| 1 3/8" (6)   | 84             |                | 107 | 58             | 20             |                |        |                |     | 21.83.40                                   | 134748                               |            |
| 1 3/8" (21)  | 84             |                | 107 | 58             | 20             |                |        |                |     | 21.83.41                                   | 134749                               |            |
| 8 x 32 x 38 (8)                                    | 84             |                | 107 | 58             | 20             |                |        |                |     | 21.83.42                                   | 147615                               |            |
| 1 3/8" (6)   | 50             | 13             | 107 | 58             | 20             | 21,5           |        |                |     | 21.10.00                                   | 041378                               |            |
| 1 3/8" (21)  | 50             | 13             | 107 | 58             | 20             | 21,5           |        |                |     | 21.19.00                                   | 041341                               |            |
| 8 x 32 x 38 (8)                                    | 50             | 13             | 107 | 58             | 20             | 23,2           |        |                |     | 21.18.124                                  | 045163                               |            |
| 1 3/8" (6)   | 50             | M12            | 107 | 58             | 20             | 21,5           |        |                |     | 21.29.00                                   | 041356                               |            |
| 1 3/8" (21)  | 50             | M12            | 107 | 58             | 20             | 21,5           |        |                |     | 21.10.110                                  | 097671                               |            |
| 30 H8  | 50             | M12            | 107 | 58             | 20             | 19             | 8 JS9  | 33,3           |     | 21.29.02                                   | 041360                               |            |
| 35 H8  | 50             | M12            | 107 | 58             | 20             | 21,5           | 10 JS9 | 38,3           |     | 21.18.02                                   | 041333                               |            |
| 30 H8  | 56             | 10 H12         | 95  | 46             | 20             |                |        |                |     | 21.30.04                                   | 041472                               |            |
| 35 H8  | 56             | 13 H12         | 95  | 46             | 20             |                |        |                |     | 21.24.01                                   | 041408                               |            |
| 1 3/8" (6)   | 56             | 8 H12          | 95  | 46             | 20             |                |        |                |     | 21.30.105                                  | 041624                               |            |
| 30 H8  | 56             |                | 95  | 46             | 20             |                | 8 JS9  | 33,3           | M12 | 21.30.07                                   | 041475                               |            |
| 35 H8  | 56             |                | 95  | 46             | 20             |                | 10 JS9 | 38,3           | M12 | 21.24.03                                   | 041410                               |            |
| 0v   |                | 10 H12         | 85  | 36             | 22             |                |        |                |     | 21.11.00                                   | 041315                               |            |
| 1  |                | 10 H12         | 85  | 36             | 22             |                |        |                |     | 21.12.00                                   | 041318                               |            |
| <b>Gelenkkreuz / Cross joint / Bloc croisillon</b> |                |                |     |                |                |                |        |                |     | 21.00.00                                   | 044444                               |            |

### Identifizierung – Maßtabelle / Identification – Table of dimensions / Identification – Tableau des cotes

| Baugröße<br>Size<br>Dimension | Gelenkkreuz<br>Cross joint<br>Bloc croisillon | Gabel<br>Yoke<br>Mâchoire | Profilpaarungen<br>Profile matings<br>Profils int./ext. | Schutzrohre<br>Guard tubes<br>Tubes protecteurs | SC/SD     |
|-------------------------------|---|---------------------------|---|---|-----------|
| <b>W 400 E</b>                |   |                           | <br><b>1b</b> <b>2a</b>                                 |   | <b>25</b> |

### Schutztrichter Guard cones Cônes protecteurs

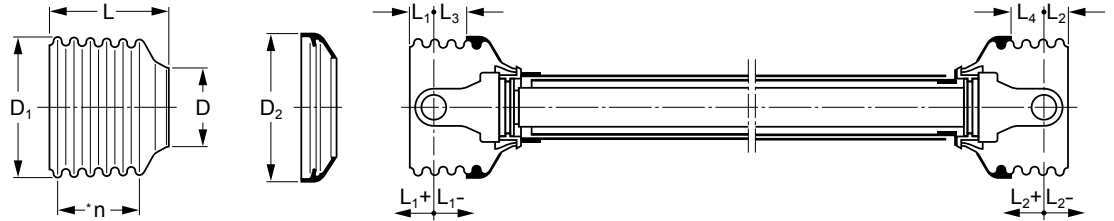

### SD 25/ SC 25

|    |                |                |     |                |                |                |                |    | Schutztrichter<br>Guard cones<br>Cônes protecteurs |                                      | Stützring<br>Reinforcing collar<br>Bague de renfort |                                      |
|----|----------------|----------------|-----|----------------|----------------|----------------|----------------|----|--|--------------------------------------|---|--------------------------------------|
| D  | D <sub>1</sub> | D <sub>2</sub> | L   | L <sub>1</sub> | L <sub>2</sub> | L <sub>3</sub> | L <sub>4</sub> | *n | Zeichn.-Nr.<br>Drawing No.<br>Réf. du plan         | Bestell-Nr.<br>Part No.<br>Référence | Zeichn.-Nr.<br>Drawing No.<br>Réf. du plan          | Bestell-Nr.<br>Part No.<br>Référence |
| 85 | 158            | 165            | 129 | 38             | 28             | 36             | 46             | 6  | 85.25.06   | 365366                               | 82.85.00  | 359471                               |
|    | 156            |                | 200 | 109            | 99             |                |                | 10 | 85.25.10   | 365370                               |   |                                      |

\*n = Rippenzahl (Andere Ausführungen auf Anfrage)

\*n = No. of ribs (Other versions on request)

\*n = Nombre d'ondes (Autres versions sur demande)

### Gelenkwellenanschlüsse – Gelenkkreuz / Drive shaft yokes – Cross joint / Accouplements correspondants – Bloc croisillon

| D  | D <sub>1</sub> | D <sub>2</sub> | L   | L <sub>1</sub> | L <sub>2</sub> | L <sub>3</sub> | N      | N <sub>1</sub> | G   | Zeichn.-Nr.<br>Drawing No.<br>Réf. du plan | Bestell-Nr.<br>Part No.<br>Référence |  |
|--|----------------|----------------|-----|----------------|----------------|----------------|--------|----------------|-----|--|--------------------------------------|--|
| 1 3/8" (6)   | 56             | 13             | 112 | 62             | 24             | 21,5           |        |                |     | 35.10.00                                   | 056699                               |  |
| 1 3/8" (21)  | 56             | 13             | 112 | 62             | 36             | 21,5           |        |                |     | 35.10.02                                   | 019516                               |  |
| 8 x 32 x 38 (8)                                    | 56             | 13             | 112 | 62             | 24             | 23,2           |        |                |     | 35.10.108                                  | 341087                               |  |
| 1 3/8" (6)   | 84             |                | 112 | 62             | 24             |                |        |                |     | 35.83.40                                   | 134750                               |  |
| 1 3/8" (21)  | 84             |                | 112 | 62             | 24             |                |        |                |     | 35.83.41                                   | 134751                               |  |
| 8 x 32 x 38 (8)                                    | 84             |                | 112 | 62             | 24             |                |        |                |     | 35.83.42                                   | 147616                               |  |
| 1 3/8" (6)   | 56             | M12            | 112 | 62             | 24             | 21,5           |        |                |     | 35.10.04                                   | 319208                               |  |
| 1 3/8" (21)  | 56             | M12            | 112 | 62             | 24             | 21,5           |        |                |     | 35.10.06                                   | 320684                               |  |
| 35 H8  | 56             | M12            | 112 | 62             | 24             | 21,5           | 10 JS9 | 38,3           |     | 35.18.06                                   | 320687                               |  |
| 35 H8  | 66             |                | 112 | 62             | 20             |                | 10 JS9 | 38,3           | M12 | 35.24.12                                   | 320695                               |  |
| 40 H8  | 66             |                | 112 | 62             | 20             |                | 12 JS9 | 43,3           | M12 | 35.24.10                                   | 321910                               |  |
| 1 3/8" (6)   | 66             | 8 H12          | 105 | 55             | 20             |                |        |                |     | 35.22.106                                  | 320693                               |  |
| 35 H8  | 66             | 13 H12         | 105 | 55             | 20             |                |        |                |     | 35.22.00                                   | 320688                               |  |
| 40 H8  | 66             | 13 H12         | 112 | 62             | 20             |                |        |                |     | 35.24.13                                   | 320689                               |  |
| 1b   |                | 10 H12         | 92  | 42             | 29             |                |        |                |     | 35.13.00                                   | 019518                               |  |
| 2a   |                | 10 H12         | 102 | 52             | 39             |                |        |                |     | 35.14.00                                   | 019519                               |  |
| <b>Gelenkkreuz / Cross joint / Bloc croisillon</b> |                |                |     |                |                |                |        |                |     | 35.00.00                                   | 312410                               |  |



| Type<br>Désignation | Typ<br>Mmax. [Nm]<br>(inlb) | n max.*<br>[min <sup>-1</sup> ] | Baugröße / Size / Dimension |         |         |         | Anschlüsse<br>Connections<br>Accouplements |
|---------------------|-----------------------------|---------------------------------|-----------------------------|---------|---------|---------|--|
|                     |                             |                                 | L = mm                      |         |         |         |  |
|                     |                             |                                 | W 100 E                     | W 200 E | W 300 E | W 400 E |  |

**Sternratsche / Radial pin clutch / Limiteur à cames en étoile**

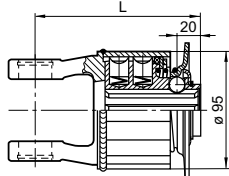

|   |                 |                                  |               |               |               |                 |  |
|---|-----------------|----------------------------------|---------------|---------------|---------------|-----------------|--|
| <b>K31B</b>   | 300<br>(2655)   | ca.<br>approx.<br>environ<br>700 | 101           |               |               |                 | 1 3/8" (6)<br>mit Ziehverschluss<br>with push-pull-lock<br>avec<br>verrouillage rapide<br>à billes |
| <b>K32B</b>   | 600<br>(5310)   |                                  | 120           | 126           | 136           |                 |  |
| <b>K33B</b>   | 900<br>(7965)   |                                  |               | 145           | 155           |                 |  |
| <b>K34B</b>   | 1200<br>(10620) |                                  |               |               | 174           | 182             |  |
| Gelenkwelle Mzul.<br>Drive shaft Mmax.<br>Couple admissible<br>de la transmission |                 | [Nm]<br>(inlb)                   | 400<br>(3540) | 800<br>(7080) | 900<br>(7965) | 1500<br>(13275) |  |

**Scherbolzenkupplung / Shear bolt clutch / Limiteur à boulon de rupture**

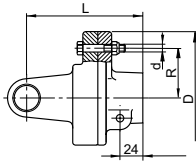

|   |                 |                                   |  |                 |                 |                 |   |
|---|-----------------|-----------------------------------|--|-----------------|-----------------|-----------------|---|
| <b>K61/1</b>  | 1400<br>(12390) | ca.<br>approx.<br>environ<br>1000 |  | 123             |                 |                 | 1 3/8" (6)<br>mit Schiebestift<br>with quick-<br>disconnect pin<br>à poussoir |
| <b>KB61/20</b>  | 4800<br>(42480) |                                   |  |                 | 126             | 129             |   |
| Gelenkwelle Mzul.<br>Drive shaft Mmax.<br>Couple admissible<br>de la transmission |                 | [Nm]<br>(inlb)                    |  | 1400<br>(12390) | 1600<br>(14160) | 2500<br>(22125) |   |

**Reibkupplung / Friction clutch / Limiteur à friction**

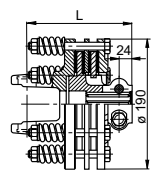
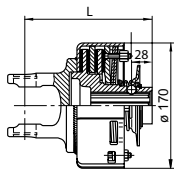
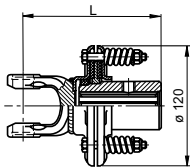

|   |                 |                                   |               |               |               |                 |   |
|---|-----------------|-----------------------------------|---------------|---------------|---------------|-----------------|---|
| <b>K94/1</b>  | 400<br>(3540)   | ca.<br>approx.<br>environ<br>1000 | 128           |               |               |                 | 1 3/8" (6)-M10  |
| <b>K92</b>  | 750<br>(6638)   |                                   | 127           | 137           |               |                 | 1 3/8" (6)<br>mit Ziehverschluss<br>with push-pull lock<br>avec verrouillage<br>rapide à billes |
| <b>K92/4</b>  | 1350<br>(11948) |                                   | 169           | 173           |               |                 | 1 3/8" (6)<br>mit Klemmschraube<br>with clamp bolt<br>avec serrage à pince                      |
| <b>K90</b>  | 1200<br>(10620) |                                   | 134           | 129           |               |                 |   |
| <b>K90/4</b>  | 2200<br>(19470) |                                   |               |               |               | 149             |   |
| Gelenkwelle Mzul.<br>Drive shaft Mmax.<br>Couple admissible<br>de la transmission |                 | [Nm]<br>(inlb)                    | 400<br>(3540) | 800<br>(7080) | 900<br>(7965) | 1500<br>(13275) |   |

**Sperrkeil-Freilaufkupplung / Key-type overrun clutch / Roue libre à rochets**

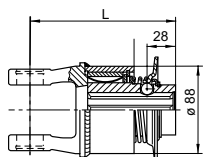

|             |                 |                                   |     |     |     |     |   |
|-------------|-----------------|-----------------------------------|-----|-----|-----|-----|---|
| <b>F5/1</b> | 3000<br>(26550) | ca.<br>approx.<br>environ<br>1000 | 133 | 139 | 149 | 157 | 1 3/8" (6)<br>mit Ziehverschluss<br>with push-pull lock<br>avec verrouillage<br>rapide à billes |
|-------------|-----------------|-----------------------------------|-----|-----|-----|-----|---|

**WALTERSCHEID**

**WALTERSCHEID GMBH**

Hauptstraße 150  
D-53797 Lohmar, Germany  
Tel.: +49 2246 12-0  
Fax: +49 2246 12-3501  
[www.walterscheid.com](http://www.walterscheid.com)

Überreicht durch:  
With the compliments of:  
Distribu  par:



Walterscheid  
– The original

