

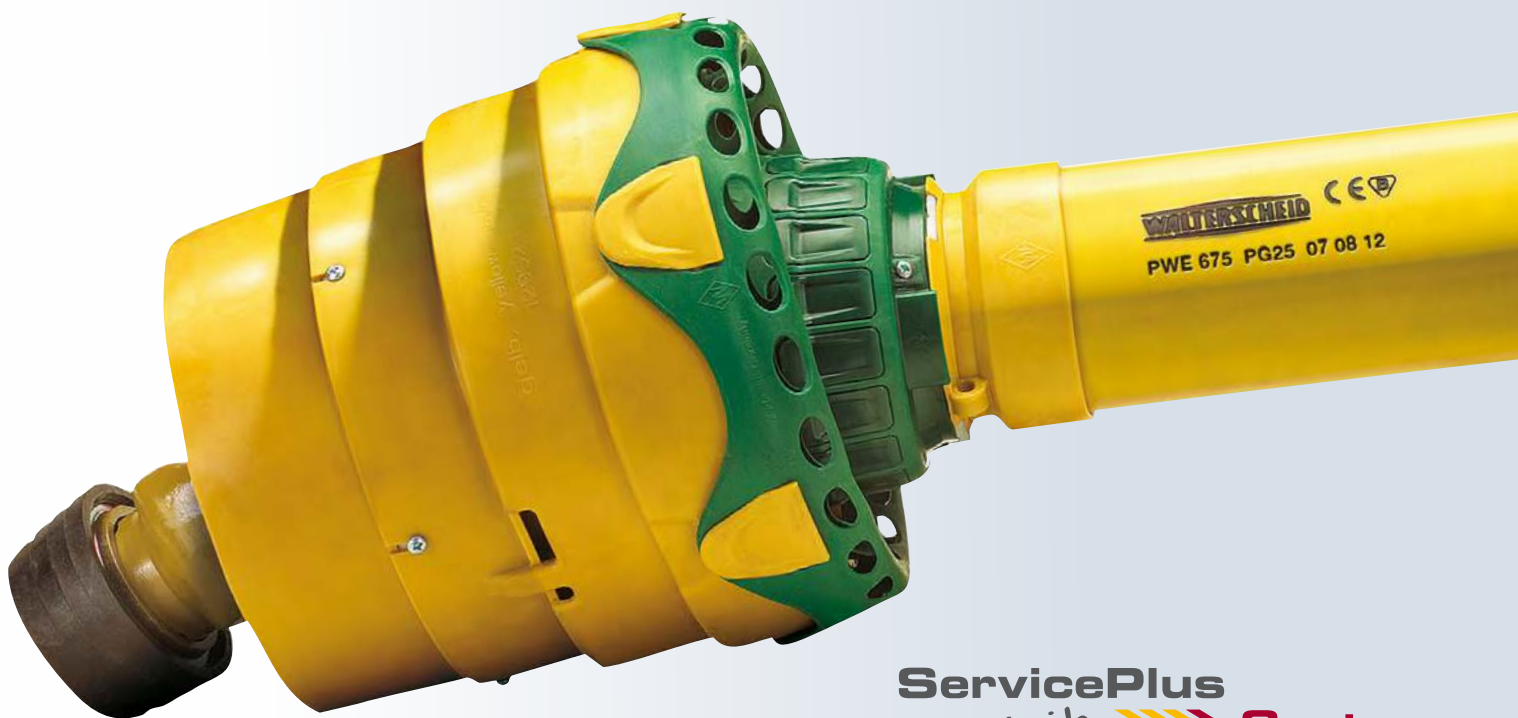

**PRODUCT INFORMATION**

Driveshafts >

**POWER DRIVE P 675 WIDE-ANGLE JOINT**  
INNOVATIVE DETAILS FOR MAXIMUM DEPENDABILITY



**ServicePlus**  
inside  **System**  
powered by Walterscheid

# THE NEW MOBILITY OF POWER

The new P 675 wide-angle joint from Walterscheid offers the user substantially greater benefits and is characterised by numerous technical innovations in practical use.

## ► Readily accessible grease nipples

The P 675 wide-angle joint has a new kind of central lubrication system which – in conjunction with the cap bottom lubrication that has already demonstrated its worth in standard joints – permits an optimum flow of grease straight to the heart of the joint.

## ► 60-hour maintenance interval

Floating disks make for a permanently closed centring system. This minimises grease losses and prevents the ingress of dirt. Depending on application, the new wide-angle joint only needs to be lubricated after every 60 hours of operation as a result of this technical innovation – generally meaning once per week.

## ► Longer service life

The floating disks and the spherical plain bearings integrated in the centring system ensure optimum distribution of forces. This reduces wear and prolongs the service life of the joint. The double yoke is additionally characterised by a revised lubrication system.

All components are optimally supplied with grease via a bilateral central lubrication system and direct double-yoke lubrication. The centring system of the joint is equipped with a wear-resistant guide hub made of high-strength material.

The tried-and-tested spherical plain bearings and floating disks increase the service life of the centring system by improving the distribution of forces. These components moreover prevent the ingress of dirt and the escape of grease.

## ► Great functional reliability

The Power Drive P 675 wide-angle joint features the familiar product characteristics of the Walterscheid Power Drive range, such as dirt-repellent multi-lip seals and robust needle bearing technology. The completely enclosed design affords protection against environmental influences and the ingress of dust or residue of the harvested crop. The new generation of P 675 wide-angle joints from Walterscheid is additionally characterised by quieter running.

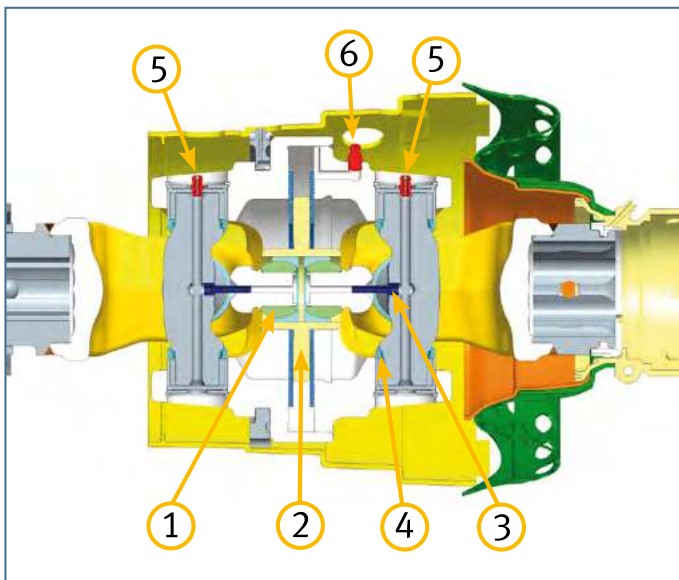

## The new generation of P 675 wide-angle joints – Consistent advancement of time-proven technology

High-quality spherical plain bearings (1) reduce wear on the guide system. When the joint is angled, floating disks with grease chambers (2) prevent an opening forming, through which grease could escape and dirt particles could get in. This increases the service life of the guide system.

The central lubrication system (3) supplies the joint with sufficient grease. The crosses are equipped with the blue P-seal (4). Cap bottom lubrication (5) and direct double-yoke lubrication (6) facilitate greasing.

## P 675 DIMENSIONS

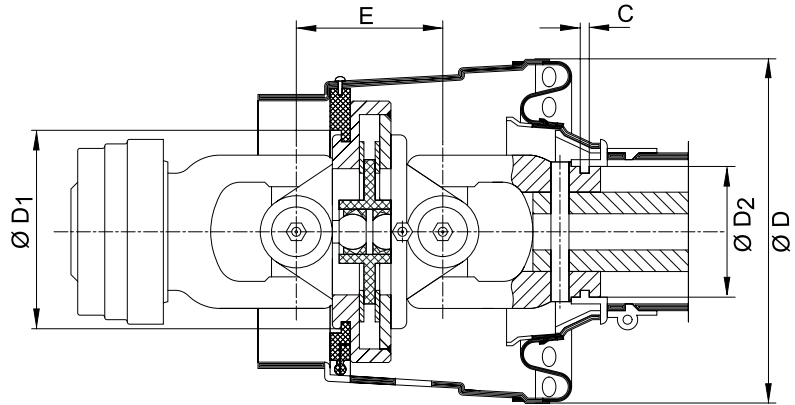
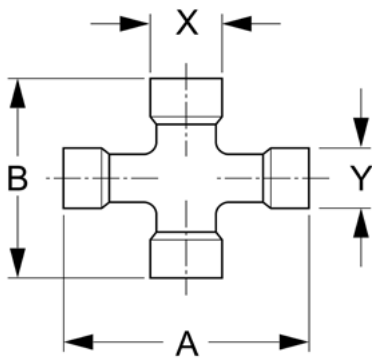

| Size  | Cross |    |     |    | Double yoke |     | Inboard yoke |     | Guard cone |
|-------|-------|----|-----|----|-------------|-----|--------------|-----|------------|
|       | A     | Y  | B   | X  | E           | ØD1 | C            | ØD2 | D          |
| P 675 | 124   | 36 | 104 | 42 | 124         | 138 | 5            | 70  | 242        |

## TABLE OF POWER RATING

| Size | Limit values   |                | Dynamic capacity                                     |                                     |  |                                     |
|------|----------------|----------------|--|-------------------------------------|--|-------------------------------------|
|      |                |                | 1 $\frac{540/\text{min}^{-1}}{1000/\text{min}^{-1}}$ |                                     | 2 $\frac{540/\text{min}^{-1}}{1000/\text{min}^{-1}}$ |                                     |
|      | Ms [Nm] (inlb) | Mp [Nm] (inlb) | P [KW] (PS)  | Mn [Nm] (inlb)                      | P [KW] (PS)  | Mn [Nm] (inlb)                      |
| P675 | 3335 (29515)   | 8000 (70805)   | <u>103 (140)</u><br>158 (215)                        | <u>1823 (16135)</u><br>1512 (13380) | <u>163 (222)</u><br>251 (341)                        | <u>2889 (25570)</u><br>2396 (21205) |

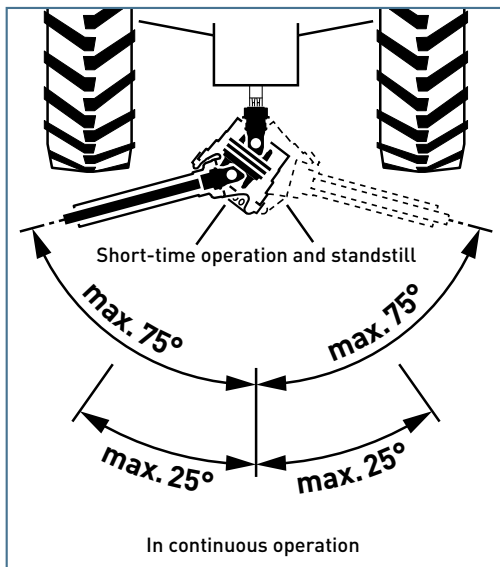

### WIDE-ANGLE JOINT:

- 1 Joint angle 10°:  
Life 1.000 h
- 2 Joint angle 18°:  
Life 100 h

### Important note:

The maximum angle per wide-angle joint is 75°. Larger angles cause forcible damage. The angle in continuous operation must not exceed 25°. Wide-angle PTO drive shafts are no substitute for angular gearboxes.



**WALTERSCHEID GMBH**

Hauptstraße 150  
D-53797 Lohmar  
Tel.: +49 2246 12-0  
Fax: +49 2246 12-3501  
[www.walterscheid.com](http://www.walterscheid.com)

The Walterscheid GmbH is a  
company of Walterscheid  
Powertrain Group



Find out more about Walterscheid